

# RALLY CAMERA

Setup Guide | Guide d'installation

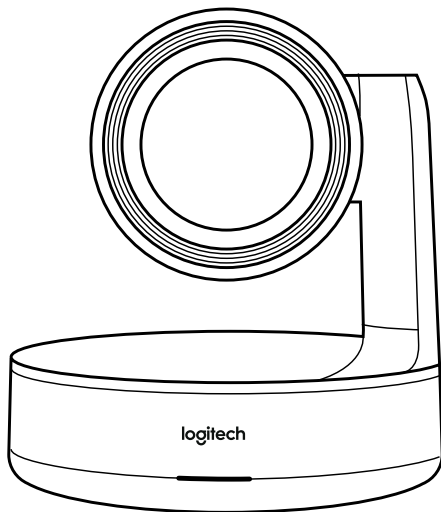

logitech® JUST•PROJECTORS

# WHAT'S IN THE BOX JUST•PROJECTORS

INTERACTIVE  
PANELS UK

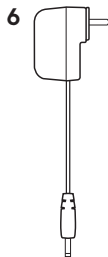
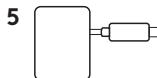
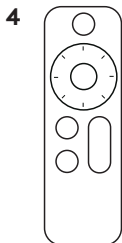
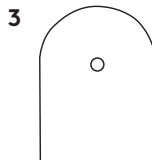
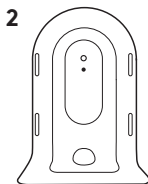
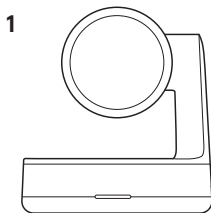

- 1. Camera
- 2. Camera Mount
- 3. Power Splitter Case
- 4. Remote

- 5. Power Splitter
- 6. Power Adapter
- 7. USB Cable
- 8. Documentation

# WHAT'S WHAT CAMERA

JUST•PROJECTORS

INTERACTIVE  
PANELS UK

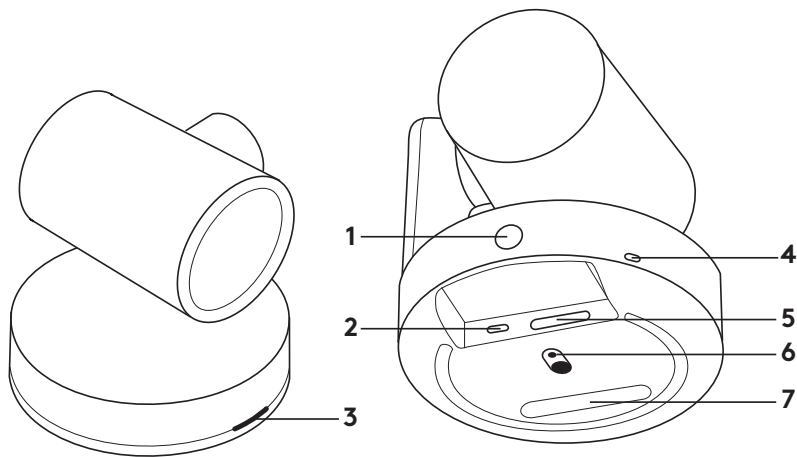

- 1. Remote Pairing Button
- 2. USB
- 3. Status LED

- 4. Security Slot
- 5. MIPI
- 6. Tripod Thread
- 7. Expansion Slot

## REMOTE

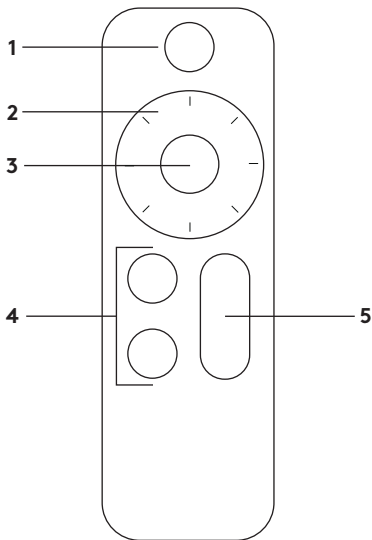

- 1.** Video Mute
- 2.** Pan/Tilt
- 3.** Camera Home

- 4.** Camera Presets
- 5.** Zoom In/Out

## CONNECT YOUR CAMERA

Connecting Rally Camera is the same whether you plan on using a dedicated computer in the room, or your team members bring a laptop to the room to run the meeting.

1. Plug the power splitter USB pigtail into the USB port of the camera.

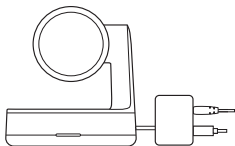

2. Connect the power adapter from the power splitter to a wall outlet.

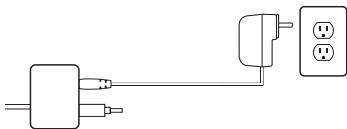

3. Connect the USB cable from the power splitter to your computer.

4. The status LED will flash when the camera is connecting. Once complete, the camera head will rotate.

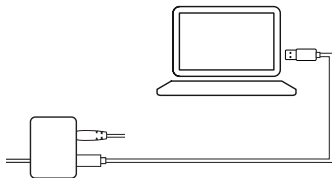

5. If issues persist, consult [www.logitech.com/support/rallycamera](http://www.logitech.com/support/rallycamera) or call technical support.

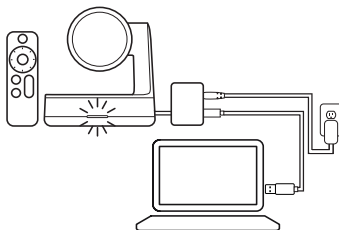

## MOUNT YOUR CAMERA

We offer a number of options to mount your Rally Camera. For video calls, we recommend placing the camera as close to eye level as possible. Best results typically come from mounting below the TV.

**1.** Place on a table or shelf near the TV.

**2.** Mount on the wall:

- a.** Attach wall mount to the wall.  
Please use the appropriate screw type for your wall type.



- b.** Insert the power splitter into the power splitter case and route cables as shown.

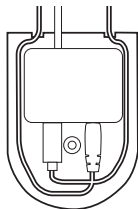

- c.** Thread the USB pigtail through the hole in the bottom of the mount and connect to the camera.

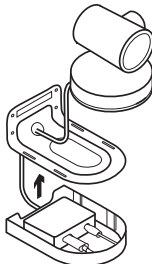

- d.** Latch the power splitter case to the mount.



- e.** Secure the camera to the mount via the tripod screw.

- 3.** Mount to the TV: An optional TV mount bracket is available at [www.logitech.com](http://www.logitech.com).

## STARTING THE VIDEO CALL

To start a video call/capture session, start your application of choice and select the Rally Camera. The status LED will illuminate when video is streamed.

**Note regarding 4K video:** The USB 2.0 cable included with Rally Camera supports Full HD video (up to 1080p). If you require 4K video, please use a USB 3.0 cable (not included).

## PAN AND TILT

Press once for incremental movement or press and hold for continuous pan and tilt.

**Caution:** Manually rotating camera head may damage the device.

## CAMERA PRESETS

Set up to 2 preset positions. Once in the desired position, save a preset by pressing and holding the button for 3 seconds. Return to the desired position at any time by pressing the button once

## HOME

Home will be the position the camera moves to when the camera is started. Save a new Home position by holding the button for 10 seconds.

## CAMERA SETTINGS APPLICATION

Use this program to control the camera pan, tilt, zoom, focus, and image quality (like brightness and contrast). The software can be downloaded from [www.logitech.com/support/rallycamera](http://www.logitech.com/support/rallycamera)

## RIGHTSIGHT

This function to automatically frame the people in the room will be downloaded after the camera is first connected to a computer (Windows only). To enable the function on a Mac or if the download is blocked on Windows, install the Camera Settings Application. RightSight will run at the start of a video call/capture session and on demand by pressing the Home button. To disable the RightSight function, use the Camera Settings Application.

## PAIRING THE REMOTE

Your camera and remote control are paired at the factory. However, if you need to pair a remote to the camera (such as when replacing a lost remote) do the following:

1. Press and hold button on the back of the camera until LED flashes blue.
2. Press and hold the Video Mute button on the remote for 10 seconds to place it in pairing mode.
3. Once the remote and camera are paired the LED will stop flashing
4. If the pairing fails, the LED will keep flashing. Start from step 2 and repeat.

## FOR MORE INFORMATION

You can find additional information on Rally including:

- FAQs
- Firmware Upgrades
- Software Downloads
- Support Community
- Warranty Information
- Replacement Parts
- And more at  
**[www.logitech.com/support/rallycamera](http://www.logitech.com/support/rallycamera)**





© 2018 Logitech. Logitech, Logi and other Logitech marks are owned by Logitech and may be registered. All other trademarks are the property of their respective owners. Logitech assumes no responsibility for any errors that may appear in this manual. Information contained herein is subject to change without notice.

© 2018 Logitech. Logitech, Logi et les autres marques Logitech sont la propriété de Logitech et sont susceptibles d'être déposées. Toutes les autres marques sont la propriété exclusive de leurs détenteurs respectifs. Logitech décline toute responsabilité en cas d'erreurs dans ce manuel. Les informations énoncées dans le présent document peuvent faire l'objet de modifications sans avis préalable.