



RA-Studfix-V1 and RA-Studfix-V2 System

Installation Instructions

The Ra technology RA Studfix V1 and V2 System are designed for installing Flat Screens onto Wooden Stud Partition or Solid Walls. These instructions are provided on the assumption that the wall the system is being fixed to is suitable for this type of installation. The following instructions detail how the system needs to be fixed to the wall for a safe and effective installation.

- 1) If fixing to a Stud Partition Wall, first find the location of two **VERTICAL** wooden studs inside the wall (behind the plaster board surface). These are normally between 400mm and 600mm apart (centre to centre) in most wooden stud partition walls. It is important you locate the CENTRE point of both vertical studs and clearly mark their location as this is the point where the coach screws (included) in the kit will fix the Wall Mounting Plate to the wall. It is advisable to use a spirit level to ensure your markings are 100% vertical and horizontal.
- 2) Fit the **Floor Plate** to the bottom of both **Upright Legs** as seen in step 1. Ensure the **Upright Legs** are fitted with the two large round cable exit / entry holes facing back towards the wall and the threaded holes for the Wall Mounting Plate facing outwards. This is easier to do with the **Floor Plate** and **Upright Legs** positioned flat on the floor.
- 3) Next fit the **Wall Mounting Plate** to the left and right outside face of each leg using two bolts and washers. At this stage do not fully tighten these four bolts (two on each leg) as shown in step 2. There are two positions for mounting the legs onto the **Wall Mounting Plate**. One is for use when fitting to a flat wall and the other (furthest out) is for use when fitting RA Studfix Systems to a wall with surface mounted Dado Rails or Network Trunking. Please fix as appropriate. The **Wall Mounting Plate** can also be positioned at various heights onto the legs.
- 4) At this stage if you know the height you want the flat screen to be fixed at once the RA Studfix System is fixed to the wall then fit the **Flat Screen Mount Plate** at the required height on the front outer face of each **Upright Leg** with 4 bolts as shown in Step 3. If not, the **Flat Screen Mount** can be fitted later.
- 5) Next route any connection cables being used to and from the screen through the centre of one or both **Upright Legs** as shown in Step 4. It is easier to do this at this stage with the RA Studfix System still on the floor than when it is fixed to the wall as the cable exit / entry holes face back towards the wall surface.
- 6) Now position the RA Studfix System against the wall surface vertically and align the horizontal slots in the **Wall Mounting Plate** with the centres of the Wooden Studs as previously marked and make four pilot holes in the plaster at the appropriate points for the four Coach Screws to be fitted as shown in Step 5. A Plastic M6 Washer and Metal M6 Washer are used with each Coach Screw (metal washer against Coach Screw head). Check positioning of RA Studfix System with a spirit level before tightening the four Coach Screws. Once tightened place the plastic caps on the heads of all four Coach Screws as seen in Step 6. The **Floor Plate** has two holes in its base plate to allow for fixing to the floor if required with appropriate fixings (not included).
- 7) After fitting the **Flat Screen Mount** to RA Studfix System (if not already fitted) fit the two **Flat Screen Mounting Legs** (left and right) on the rear of the Flat Screen and lift onto the **Flat Screen Mount** in a central position and carefully tighten the two M6 retaining bolts on the underside of each leg. The **Black Plastic Caps** can now be inserted into the top of each **Upright Leg** as shown in Step 7.
- 8) Now fully tighten the two bolts on the outside of each **Upright Leg** through the **Wall Mounting Plate** as shown in Step 8. This now completes the installation of RA Studfix System.

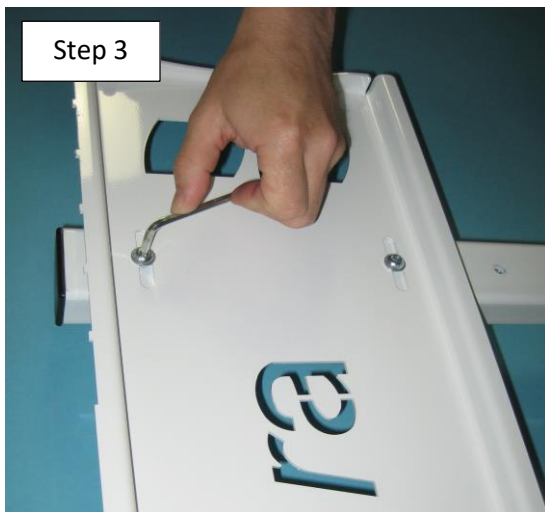
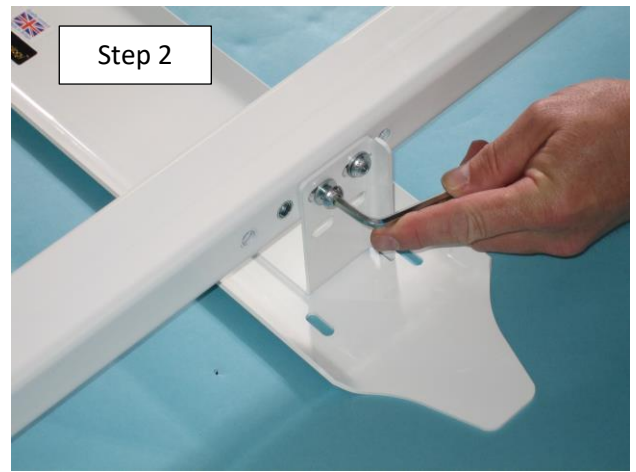
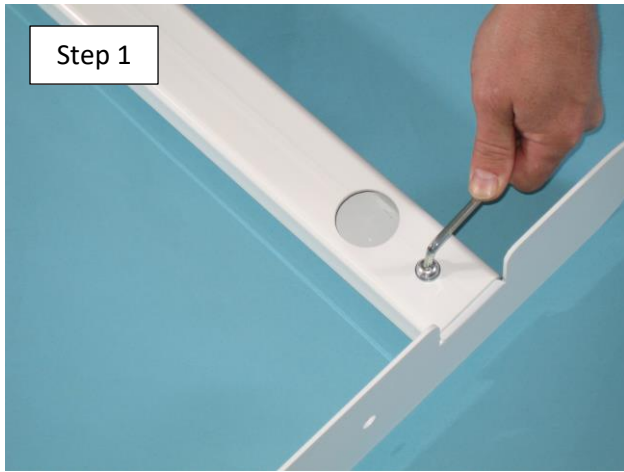

For additional support or assistance with installation of this or any other Ra technology Product please contact customer services on 01484 475950

RA Studfix V2

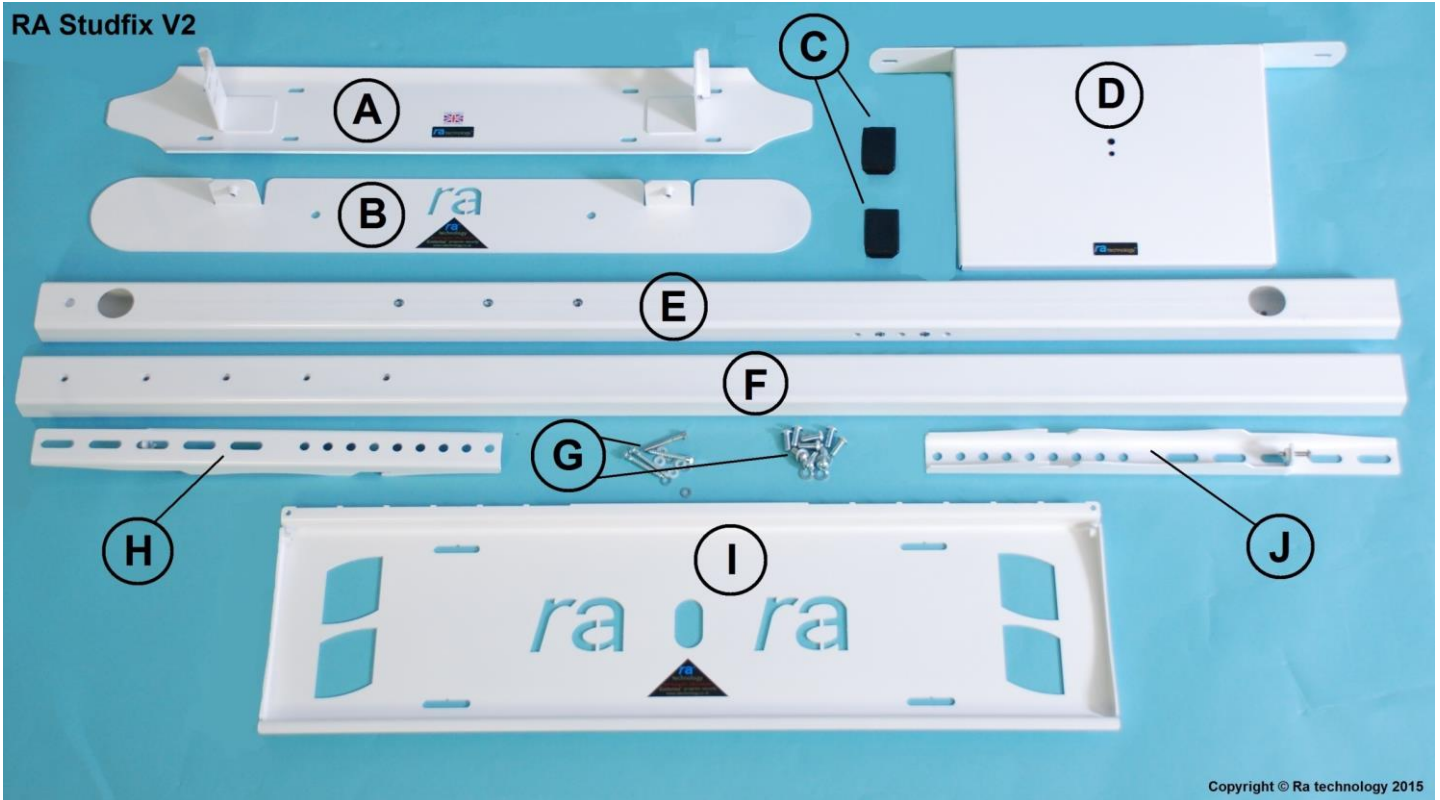

Copyright © Ra technology 2015

- A) Wall Mounting Plate
- B) Floor mounting Plate
- C) Black Plastic Caps for top of Upright Legs x 2
- D) Media Shelf (Optional Extra)
- E) Right Hand Upright Leg
- F) Left Hand Upright Leg
- G) Bolt / Screw / Washer Kit
- H) Left Flat Screen Mounting Leg
- I) Flat Screen Mount
- J) Right Flat Screen Mounting Leg

JUST•PROJECTORS

